



RL 12

Hydropneumatic tool for installing 2.4 mm to 5.0 mm blind rivets

Benefits at a glance

- Low-weight
- Exceptionally ergonomic
- Transparent spent mandrel container
- Replacement nose pieces on base of tool
- Air supply fittable on left or right
- Fast installation speed

Technical specifications

Stroke:	14.0 mm
Insertion force:	8.0 kN at 6 bar
Installation force/Weight ratio:	5.7 kN/kg
Air consumption per installed rivet:	approx. 2.0 l / blind rivet
Connection pressure:	5 - 7 bar
Air supply:	ø 6 mm (G1/4")
Weight:	1.4 kg

Scope of delivery

RL12 rivet installation tool
 Nose pieces: 3.0 / 3.2 mm; 4.0 mm; 4.8 / 5.0 mm
 Oil injector
 Angled air supply
 Operating instructions
Article No. 431 180 000

Working range

Rivet Ø [mm]	2.4*	3.0/3.2	4.0	4.8/5.0	6.0	6.4
Aluminium, copper	•	•	•	•		
Steel	•	•	•	•		
Stainless steel	•	•	•	•		

* Not suitable for cup-type blind rivets.

Spare parts / Consumables

Description	Article No.
Nose piece 2.4 mm	431 451 870
Nose piece 3.0 / 3.2 mm	431 303 870
Nose piece 4.0 mm	431 304 870
Nose piece 4.8 / 5.0 mm	431 305 870
Jaws, 3-piece set	431 455 002



RL 15A



Hydropneumatic tool for installing 2.4 mm - 5.0 mm blind rivets, long stroke

Benefits at a glance

- Tool with long stroke for installing rivets with a large grip range or for soft materials
- Cost-saving - spent mandrel extractor triggers when the tool is picked up by its handle
- Low-noise
- Easy to use; requires little maintenance
- Air supply fittable on left or right
- Replacement nose piece retainer on base of tool
- Safety valve prevents operating pressure overload
- Reliable and tried-and-tested

Technical specifications

Stroke:	21.0 mm
Insertion force:	9.5 kN at 6 bar
Installation force/Weight ratio:	5.6 kN/kg
Air consumption:	approx. 2 l / blind rivet
Connection pressure:	5 - 7 bar
Air supply:	ø 6 mm (G1/4")
Weight:	1.6 kg

Scope of delivery

RL 15A rivet installation tool
 Nose pieces: 2.4 mm; 3.0 / 3.2 mm; 4.0 mm; 4.8 / 5.0 mm
 Oil refill set
 Angled air supply
 Operating instructions
 Article No. 431 410 200

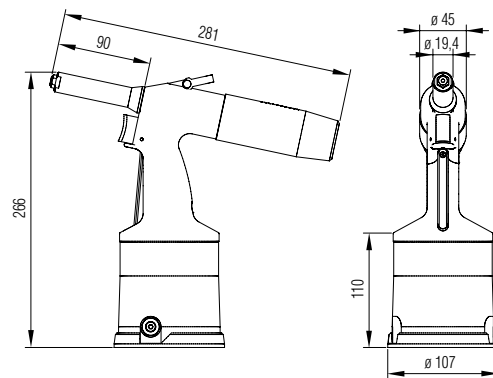

Working range

Rivet Ø [mm]	2.4*	3.0/3.2	4.0	4.8/5.0	6.0	6.4
Aluminium, copper, brass	•	•	•	•		
Steel	•	•	•	•		
Stainless steel	•	•	•	•		

* Not suitable for cup-type blind rivets.

Spare parts / Consumables

Description	Article No.
Nose piece 2.4 mm	431 451 870
Nose piece 3.0 / 3.2 mm	431 303 870
Nose piece 4.0 mm	431 304 870
Nose piece 4.8 / 5.0 mm	431 305 870
Jaws, 3-piece set	431 455 002

Optional accessories

Description	Article No.
Jaws for stainless steel flat head rivets	431 455 001
Extra-long nose cap 200 mm	431 204 870
Nose cap, ø 17 mm	431 221 870
Extra-long nose cap 200 mm / ø 17 mm	431 222 870
Hydraulic oil 1 l	460 299 870

RL 20A

Hydropneumatic tool for installing 2.4 mm to 5.0 mm blind rivets

Benefits at a glance

- Cost-saving – spent mandrel extractor triggers when the tool is picked up by its handle
- Low-noise
- Easy to use; requires little maintenance
- Air supply fittable on left or right
- Air volume settings for spent mandrel extractor located on detachable spent mandrel container
- Replacement nose piece retainer on base of tool
- Safety valve prevents operating pressure overload
- Reliable and tried-and-tested

Technical specifications

Stroke:	16.0 mm
Insertion force:	13.0 kN at 6 bar
Installation force/Weight ratio:	8.1 kN/kg
Air consumption:	approx. 2 l / blind rivet
Connection pressure:	5 – 7 bar
Air supply:	ø 6 mm (G1/4")
Weight:	1.6 kg

Scope of delivery

RL 20A rivet installation tool
 Nose pieces: 2.4 mm; 3.0 / 3.2 mm; 4.0 mm; 4.8 / 5.0 mm
 Oil refill set
 Angled air supply
 Operating instructions
 Article No. 431 450 650

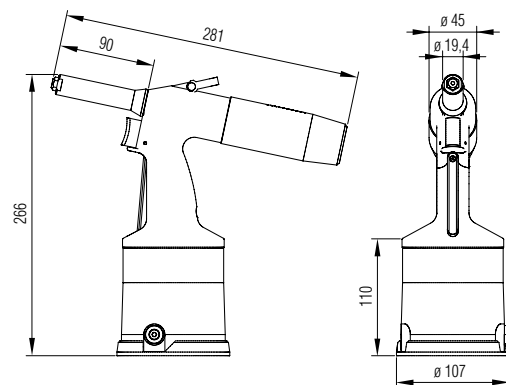

Working range

Rivet Ø [mm]	2.4*	3.0/3.2	4.0	4.8/5.0	6.0	6.4
Aluminium, copper, brass	•	•	•	•		
Steel	•	•	•	•		
Stainless steel	•	•	•	•		

* Not suitable for cup-type blind rivets.

Spare parts / Consumables

Description	Article No.
Nose piece 2.4 mm	431 451 870
Nose piece 3.0 / 3.2 mm	431 303 870
Nose piece 4.0 mm	431 304 870
Nose piece 4.8 / 5.0 mm	431 305 870
Jaws, 3-piece set	431 455 002

Optional accessories

Description	Article No.
Jaws for stainless steel flat head rivets	431 455 001
Extra-long nose cap 200 mm	431 204 870
Nose cap, ø 17 mm	431 221 870
Extra-long nose cap 200 mm / ø 17 mm	431 222 871
Hydraulic oil 1 l	460 299 870
Inductive ring sensor	431 357 000



RL 40I

Hydropneumatic tool for installing 4.0 mm - 6.4 mm blind rivets

Benefits at a glance

- Tool-less alternating jaws system
- Infinitely adjustable mandrel extractor
- Low-noise
- Easy to use; requires little maintenance
- Air supply fittable on left or right
- Quick-release mandrel container
- Replacement nose piece retainer on base of tool
- Safety valve prevents operating pressure overload
- Reliable and tried-and-tested

Technical specifications

Stroke:	14.0 mm
Insertion force:	14.7 kN at 6 bar
Installation force/Weight ratio:	7.4 kN/kg
Air consumption:	approx. 2 l / blind rivet
Connection pressure:	5 - 7 bar
Air supply:	ø 6 mm (G1/4")
Weight:	2.0 kg

Scope of delivery

RL 40I rivet installation tool
 Nose pieces: 4.0 mm; 4.8 / 5.0 mm; 6.0 mm; 6.4 mm
 Oil refill set
 Angled air supply
 Operating instructions
 Article No. 431 299 300

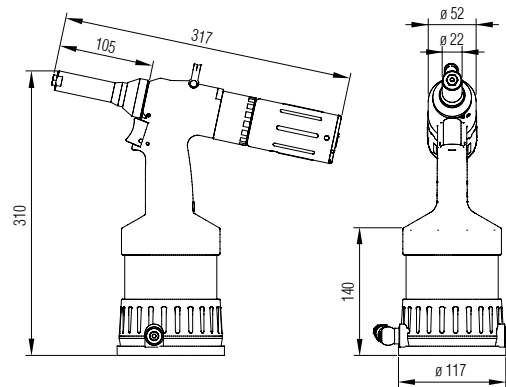

Working range

Rivet Ø [mm]	2.4	3.0/3.2	4.0	4.8/5.0	6.0	6.4
Aluminium, copper			•	•	•	•
Steel			•	•	•	•
Stainless steel			•	•	•	•

Optional accessories

Description	Article No.
Inductive ring sensor	431 784 000
Hydraulic oil 1 l	460 299 870

Spare parts / Consumables

Description	Article No.
Nose piece 4.0 mm	431 504 870
Nose piece 4.8 / 5.0 mm	431 505 870
Nose piece 6.0 mm	431 506 870
Nose piece 6.4 mm	431 507 870
Jaws, 3-piece set	326 583 002

Working range - high-strength blind rivets

Fastener	TIBULB			TIBULB Plus	HUCKLOK	Magna-Lok/ M-Lock			TIFAS M-Bolt		Magna-Bulb			BOM							
	[mm]	[mm]	[mm]	[mm]	[mm]	[mm]	[mm]	[mm]	[mm]	[mm]	[mm]	[mm]	[mm]	[mm]	[mm]	[mm]					
	4.8	6.4	7.8	6.4	6.4	4.8	6.4	9.5	4.8	6.4	4.8	6.4	7.8	4.8	6.4	7.8	9.5	12.7	15.9	19.1	
Aluminium	•								•												
Steel	•				•				•												
Stainless steel	•								•												

RL 60I

Hydropneumatic tool for installing 4.0 mm - 6.4 mm blind rivets, long stroke

Benefits at a glance

- Tool-less alternating jaws system
- New valve control for faster installation speeds
- Large stroke and high installation force
- Infinitely adjustable mandrel extractor
- Easy to use; requires little maintenance
- Air supply fittable on left or right
- Quick-release mandrel container
- Replacement nose piece retainer on base of tool
- No tools required to replace the pulling unit
- Safety valve prevents operating pressure overload
- Reliable and tried-and-tested

Technical specifications

Stroke:	26.0 mm
Insertion force:	18.2 kN at 6 bar
Installation force/Weight ratio:	7.0 kN/kg
Air consumption:	approx. 4.8 l / blind rivet
Connection pressure:	5 - 7 bar
Air supply:	ø 6 mm (G1/4")
Weight:	2.6 kg

Scope of delivery

RL 60I rivet installation tool
 Nose pieces: 4.0 mm; 4.8 / 5.0 mm; 6.0 mm; 6.4 mm
 Oil refill set
 Angled air supply
 Operating instructions
 Article No. 431 500 700

Working range

Rivet Ø [mm]	2.4	3.0/3.2	4.0	4.8/5.0	6.0	6.4
Aluminium, copper			•	•	•	•
Steel			•	•	•	•
Stainless steel			•	•	•	•

Spare parts / Consumables

Description	Article No.
Nose piece 4.0 mm	431 504 870
Nose piece 4.8 / 5.0 mm	431 505 870
Nose piece 6.0 mm	431 506 870
Nose piece 6.4 mm	431 507 870
Jaws, 3-piece set	326 583 002

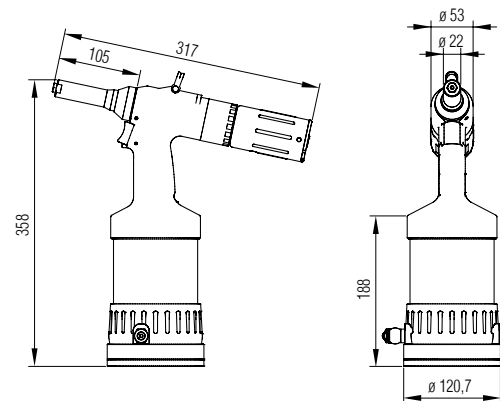

Optional accessories

Description	Article No.
Inductive ring sensor	431 784 000
Hydraulic oil 1 l	460 299 870



Working range - high-strength blind rivets

Fastener	TIBULB			TIBULB Plus	HUCKLOK	Magna-Lok/ M-Lock			TIFAS M-Bolt		Magna-Bulb			BOM						
	[mm]			[mm]	[mm]	[mm]			[mm]		[mm]			[mm]						
	4.8	6.4	7.8	6.4	6.4	4.8	6.4	9.5	4.8	6.4	4.8	6.4	7.8	4.8	6.4	7.8	9.5	12.7	15.9	19.1
Aluminium	•					•	•		•	•										
Steel	•	(•)*		(•)*	•	•	•		•	•	•	•								
Stainless steel	•								•	•	•	•								

* Can be used if tool is retrofitted with jaw case retrofit kit 431 821 870 and nose piece 431 502 870.

RL 60IHV

Hydropneumatic tool for installing 4.8 mm - 6.4 mm high-strength blind rivets, long stroke

Benefits at a glance

- For installing high-strength blind rivets
- Tool-less alternating jaws system
- New valve control for faster installation speeds
- Large stroke and high installation force
- Infinitely adjustable mandrel extractor
- Easy to use; requires little maintenance
- Air supply fittable on left or right
- Quick-release mandrel container
- Replacement nose piece retainer on base of tool
- Safety valve prevents operating pressure overload
- Reliable and tried-and-tested

Technical specifications

Stroke:	26.0 mm
Insertion force:	18.2 kN at 6 bar
Installation force/Weight ratio:	7.0 kN/kg
Air consumption:	approx. 4.8 l / blind rivet
Connection pressure:	5 – 7 bar
Air supply:	ø 6 mm (G1/4")
Weight:	2.6 kg

Scope of delivery

RL 60IHV rivet installation tool
Nose pieces: 4.8 / 5.0 mm; 6.4 mm
Oil refill set
Angled air supply
Operating instructions
Article No. 431 500 020

Working range

Rivet Ø [mm]	2.4	3.0/3.2	4.0	4.8/5.0	6.0	6.4
Aluminium, copper				•	•	•
Steel				•	•	•
Stainless steel				•	•	•

Spare parts / Consumables

Description	Article No.
Nose piece 4.8 / 5.0 mm	431 505 870
Nose piece 6.0 mm	431 506 870
Nose piece 6.4 mm	431 507 870
Nose piece 6.4 mm for TIBULB and TIBULB Plus blind rivets	431 502 870
Jaws, 3-piece set	431 561 000

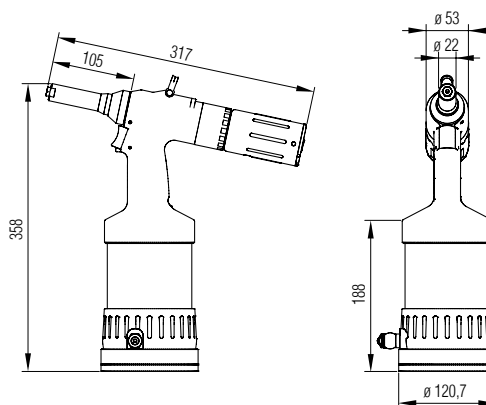

Optional accessories

Description	Article No.
Inductive ring sensor	431 784 000
Hydraulic oil 1 l	460 299 870



Working range - high-strength blind rivets

Fastener	TIBULB [mm]			TIBULB Plus [mm]	HUCKLOK [mm]	Magna-Lok/ M-Lock [mm]			TIFAS M-Bolt [mm]		Magna-Bulb [mm]			BOM [mm]						
	4.8	6.4	7.8	6.4	6.4	4.8	6.4	9.5	4.8	6.4	4.8	6.4	7.8	4.8	6.4	7.8	9.5	12.7	15.9	19.1
Aluminium	•	•		•					•	•										
Steel	•	•		•	•	•	•	•	•	•	•	•	•							
Stainless steel	•	•		•					•	•	•	•								



POP® / AVDEL® ProSet® XT1

Hydropneumatic tool for installing 2.4 mm - 4.0 mm blind rivets

Benefits at a glance

- Compact, lightweight and reliable
- High force-to-weight ratio
- Innovative ergonomic design
- Vacuum system retains and collects the rivets
- Spent mandrel container with rapid change system for easy emptying
- Very modern lip seal increases stability
- Very latest piston seal technology for maximum sturdiness



Technical specifications

Stroke:	18.0 mm
Insertion force:	6.50 kN at 5.5 bar
Installation force/Weight ratio:	5.55 kN/kg
Air consumption:	approx. 1.5 l
Connection pressure:	5 – 7 bar
Air supply:	ø 6 mm (G1/4")
Weight:	1.17 kg

Scope of delivery

1 ProSet XT1 rivet installation tool
 1 set of nose pieces
 2.4 mm, 3.2 mm, 4.0 mm
 Operating instructions
 Article No. 347 100 000

Working range

Rivet Ø [mm]	2.4	2.8/3.0/3.2	4.0	4.8/5.0	6.0	6.4
Aluminium, copper	•	•	•			
Steel	•	•	•			
Stainless steel	•	•	•			

Spare parts / Consumables

Description	Article No.
Nose piece 2.4 mm	328 619 000
Nose piece 3.2 mm	328 301 000
Nose piece 4.0 mm	328 302 000
Jaws	328 305 001
Jaw slider	347 100 100

POP® / AVDEL® ProSet® XT2



Hydropneumatic tool for installing 3.0 mm - 5.0 mm blind rivets

Benefits at a glance

- Flexible, fast and reliable
- Very high force-to-weight ratio
- Innovative ergonomic design
- Vacuum system retains and collects the rivets
- Spent mandrel container with rapid change system for easy emptying
- Very modern lip seal increases stability
- Very latest piston seal technology for maximum sturdiness

Technical specifications

Stroke:	20.00 mm
Insertion force:	8.90 kN at 5.5 bar
Installation force/Weight ratio:	7.06 kN/kg
Air consumption:	approx. 2.2 l
Connection pressure:	5 – 7 bar
Air supply:	ø 6 mm (G1/4")
Weight:	1.26 kg



Scope of delivery

1 ProSet XT2 rivet installation tool
 1 set of nose pieces
 3.2 mm, 4.0 mm, 4.8 mm
 Operating instructions
 Article No. 347 200 000

Working range

Rivet Ø [mm]	2.4	2.8/3.0/3.2	4.0	4.8/5.0	6.0	6.4
Aluminium, copper		•	•	•		
Steel		•	•	•		
Stainless steel		•	•	•		

Spare parts / Consumables

Description	Article No.
Nose piece 3.2 mm	328 301 000
Nose piece 4.0 mm	328 302 000
Nose piece 4.8 mm	328 242 000
Jaws	329 500 108
Jaw slider	347 200 100

Working range - high-strength blind rivets

Fastener	TIBULB			TIBULB Plus	HUCKLOK	Magna-Lok/ M-Lock			TIFAS M-Bolt		Magna-Bulb			BOM						
	[mm]	[mm]	[mm]	[mm]	[mm]	[mm]	[mm]	[mm]	[mm]	[mm]	[mm]	[mm]	[mm]	[mm]	[mm]	[mm]				
Aluminium	4.8	6.4	7.8	6.4	6.4	4.8	6.4	9.5	4.8	6.4	4.8	6.4	7.8	4.8	6.4	7.8	9.5	12.7	15.9	19.1
Steel						•														
Stainless steel						•														

POP® / AVDEL® ProSet® XT3

Hydropneumatic tool for installing 4.0 mm - 6.4 mm blind rivets, high-speed stroke

Benefits at a glance

- Very versatile use for a wide range of fasteners
- Large stroke for installing high-strength blind rivets
- Innovative ergonomic design
- Vacuum system retains and collects the rivets
- Spent mandrel container with rapid change system for easy emptying
- Very modern lip seal increases stability
- Very latest piston seal technology for maximum sturdiness

Technical specifications

Stroke:	26.00 mm
Insertion force:	17.00 kN at 5.5 bar
Installation force/Weight ratio:	7.94 kN/kg
Air consumption:	approx. 6.3 l
Connection pressure:	5 – 7 bar
Air supply:	ø 6 mm (G1/4")
Weight:	2.14 kg



Scope of delivery

1 ProSet XT3 rivet installation tool
 1 set of nose pieces
 4.0 mm, 4.8 mm, 6.4 mm
 Operating instructions (1 printed version) – depending on region
Article No. 347 300 000

Working range

Rivet Ø [mm]	2.4	2.8/3.0/3.2	4.0	4.8/5.0	6.0	6.4
Aluminium, copper			•	•	•	•
Steel			•	•	•	•
Stainless steel			•	•	•	•

Spare parts / Consumables

Description	Article No.
Nose piece 4.0 mm	328 302 000
Nose piece 4.8 mm	328 242 000
Nose piece 6.4 mm	328 243 000
Nose piece for 6.4 mm TIFAS® M-Bolt	342 040 240
Nose piece for 6.4 mm TIBULB®	342 060 120
Jaws	328 250 001
Jaw slider	328 707 000
Special nose piece assembly	347 300 101

Working range - high-strength blind rivets

Fastener	TIBULB®			TIBULB® Plus	HUCKLOK	Magna-Lok/ M-Lock			TIFAS® M-Bolt		Magna-Bulb			BOM							
	[mm]	[mm]	[mm]	[mm]	[mm]	[mm]	[mm]	[mm]	[mm]	[mm]	[mm]	[mm]	[mm]	[mm]	[mm]	[mm]					
	4.8	6.4	7.8	6.4	6.4	4.8	6.4	9.5	4.8	6.4	4.8	6.4	7.8	4.8	6.4	7.8	9.5	12.7	15.9	19.1	
Aluminium	•	•*			•	•	•		•	•*	•	•									
Steel	•	•*			•	•	•		•	•*	•	•									
Stainless steel	•	•*			•	•	•		•	•*	•	•									

* Requires special nose piece assembly 347 300 101 and special nose piece.



POP® / AVDEL® ProSet® XT4

Hydropneumatic tool for installing 4.0 mm - 6.4 mm blind rivets

Benefits at a glance

- Highest tensile force in its class
- High force-to-weight ratio
- High-strength piston rod for maximum service life
- Innovative ergonomic design
- Vacuum system retains and collects the rivets
- Spent mandrel container with rapid change system for easy emptying
- Very modern lip seal increases stability
- Very latest piston seal technology for maximum sturdiness

Technical specifications

Stroke:	18.00 mm
Insertion force:	23.00 kN at 5.5 bar
Installation force/Weight ratio:	10.65 kN/kg
Air consumption:	approx. 6.3 l
Connection pressure:	5 – 7 bar
Air supply:	ø 6 mm (G1/4")
Weight:	2.16 kg



Scope of delivery

- 1 ProSet XT4 rivet installation tool
- 1 set of nose pieces
- 4.0 mm, 4.8 mm, 6.4 mm
- Operating instructions
- Article No. 347 400 000

Working range

Rivet Ø [mm]	2.4	2.8/3.0/3.2	4.0	4.8/5.0	6.0	6.4
Aluminium, copper			•	•	•	•
Steel			•	•	•	•
Stainless steel			•	•	•	•

Spare parts / Consumables

Description	Article No.
Nose piece 4.0 mm	328 302 000
Nose piece 4.8 mm	328 242 000
Nose piece 6.4 mm	328 243 000
Nose piece for 6.4 mm TIFAS® M-Bolt	342 040 240
Nose piece for 6.4 mm TIBULB®	342 060 120
Nose piece for 6.4 mm TIBULB® Plus	347 300 139
Jaws	328 250 001
Jaws for 6.4 mm TIBULB® Plus	431 561 000
Jaw slider	328 707 000
Special nose piece assembly	347 300 101

Working range - high-strength blind rivets

Fastener	TIBULB			TIBULB Plus	HUCKLOK	Magna-Lok/ M-Lock			TIFAS M-Bolt		Magna-Bulb			BOM							
	[mm]	[mm]	[mm]	[mm]	[mm]	[mm]	[mm]	[mm]	[mm]	[mm]	[mm]	[mm]	[mm]	[mm]	[mm]	[mm]					
	4.8	6.4	7.8	6.4	6.4	4.8	6.4	9.5	4.8	6.4	4.8	6.4	7.8	4.8	6.4	7.8	9.5	12.7	15.9	19.1	
Aluminium	•	•*		•**	•	•	•		•	•*	•	•									
Steel	•	•*		•**	•	•	•		•	•*	•	•									
Stainless steel	•	•*		•**	•	•	•		•	•*	•	•									

* Requires special nose piece assembly 347 300 101 and special nose piece.

** Special equipment required:

Retrofit components for TIBULB® Plus blind rivets

Nose piece for 6.4 mm TIBULB® Plus - Article No. 347 300 139

Special nose piece assembly - Article No. 347 300 101

Jaws for 6.4 mm TIBULB® Plus - Article No. 431 561 000