

RL 50

Hydropneumatic blind rivet nut tool for installing M3 to M12 blind rivet nuts and M4 - M8 blind rivet studs

Benefits at a glance

- Big on performance, small in size
- One-step trigger
- Infinitely adjustable stroke
- Easy to use; requires little maintenance
- Automatic spin-off after each installation
- Low-noise
- Air supply fittable on left or right
- Spin-off action can also be triggered manually
- Safety valve prevents operating pressure overload
- Reliable and tried-and-tested

Technical specifications

Stroke:	1.5 - 5.8 mm
Insertion force:	23.5 kN at 6 bar
Installation force/Weight ratio:	10.7 kN/kg
Air consumption:	4.6 l/rivet
Air supply pressure:	5 - 7 bar
Air supply:	ø 6 mm (G1/4")
Weight:	2.2 kg

Scope of delivery

RL 50 blind rivet tool
 Threaded mandrels: M4 / M5 / M6 / M8 / M10
 Nose pieces: M4 / M5 / M6 / M8 / M10
 Oil refill set
 Angled air supply
 Operating instructions
 Article No. 348 200 250

Optional extras

RL 50A - with autospin function
 Article No. 348 200 300

RL 50S - with tool-less stroke settings
 Article No. 348 200 400

Working range

Blind rivet nuts	M3	M4	M5	M6	M8	M10	M12
Aluminium	•	*	*	*	*	•	•
Steel	•	*	*	*	*	•	•
Stainless steel	•	*	*	*	*	•	•

* For use with blind rivet studs

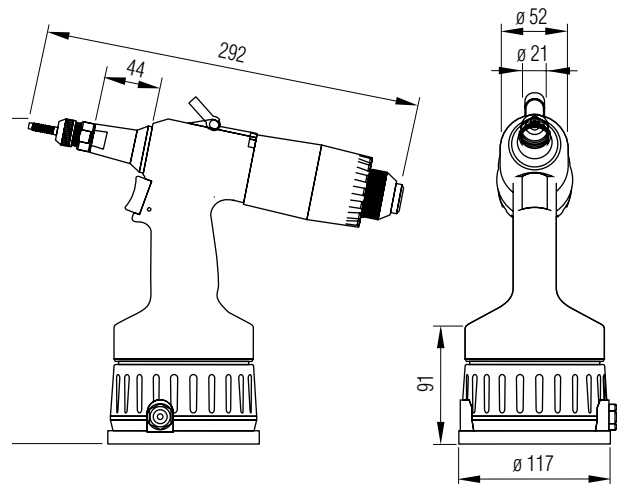

Spare parts / Consumables

Thread size	Nose piece Article No.	Threaded mandrel Article No.	Internal threaded mandrel Article No.
M3	348 213 870	348 203 870	
M4	348 214 870	348 204 870	348 224 000
M5	348 215 870	348 205 870	348 225 000
M6	348 216 870	348 206 870	348 226 870
M8	348 218 870	348 208 870	348 228 870
M10	348 220 870	348 210 870	
M12	348 222 870	348 212 000	

Optional accessories

Description	Article No.
Hydraulic oil 1 l	460 299 870



RL 50AS

Hydropneumatic blind rivet nut tool for installing M3 to M12 blind rivet nuts and M4 - M8 blind rivet studs

Benefits at a glance

- Tool-less stroke settings
- Automatic spindling (“auto-spin”)
- Big on performance, small in size
- One-step trigger
- Infinitely adjustable stroke
- Easy to use; requires little maintenance
- Automatic spin-off after each installation
- Low-noise
- Air supply fittable on left or right
- Spin-off action can also be triggered manually
- Safety valve prevents operating pressure overload



Technical specifications

Stroke:	1.5 - 5.8 mm
Insertion force:	23.5 kN at 6 bar
Installation force/Weight ratio:	10.7 kN/kg
Air consumption:	4.6 l/rivet
Air supply pressure:	5 - 7 bar
Air supply:	ø 6 mm (G1/4")
Weight:	2.2 kg

Scope of delivery

RL 50AS blind rivet tool
 Threaded mandrels: M4 / M5 / M6 / M8 / M10
 Nose pieces: M4 / M5 / M6 / M8 / M10
 Oil refill set
 Angled air supply
 Operating instructions
Article No. 348 200 500

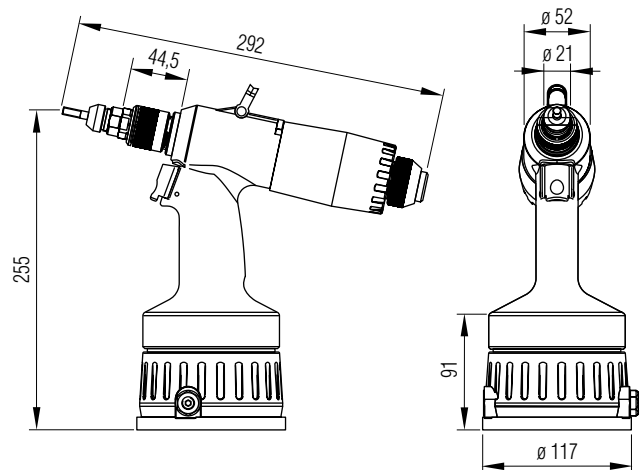

Working range

Blind rivet nuts	M3	M4	M5	M6	M8	M10	M12
Aluminium	•	•*	•*	•*	•*	•	•
Steel	•	•*	•*	•*	•*	•	•
Stainless steel	•	•*	•*	•*	•*	•	•

* For use with blind rivet studs

Spare parts / Consumables

Thread size	Nose piece Article No.	Threaded mandrel Article No.	Internal threaded mandrel Article No.
M3	348 213 870	348 203 870	
M4	348 214 870	348 204 870	348 224 000
M5	348 215 870	348 205 870	348 225 000
M6	348 216 870	348 206 870	348 226 870
M8	348 218 870	348 208 870	348 228 870
M10	348 220 870	348 210 870	
M12	348 222 870	348 212 000	

Optional accessories

Description	Article No.
Hydraulic oil 1 l	460 299 870

RL 100

Hydropneumatic blind rivet nut tool for installing M6 to M16 blind rivet nuts and M6 - M8 blind rivet studs

Benefits at a glance

- For use with sizes M6 - M16
- Big on performance, small in size
- One-step trigger
- Infinitely adjustable stroke
- Easy to use; requires little maintenance
- Automatic spin-off after each installation
- Low-noise
- Air supply fittable on left or right
- Spin-off action can also be triggered manually
- Safety valve prevents operating pressure overload
- Reliable and tried-and-tested

Technical specifications

Stroke:	2.5 - 9.0 mm
Insertion force:	34.0 kN at 6 bar
Installation force/Weight ratio:	11.7 kN/kg
Air consumption:	6.2 l/rivet
Air supply pressure:	5 - 7 bar
Air supply:	ø 6 mm (G1/4")
Weight:	2.9 kg

Scope of delivery

RL 100 blind rivet tool
Threaded mandrels: M8 / M10 / M12
Nose pieces: M8 / M10 / M12
Oil refill set
Angled air supply
Operating instructions
Article No. 348 300 250

Working range

Blind rivet nuts	M6	M8	M10	M12	M14	M16**
Aluminium	*	*
Steel	*	*
Stainless steel	*	*

* For use with blind rivet studs

** Always check first to see if the installation of M16 blind rivet nuts is possible.

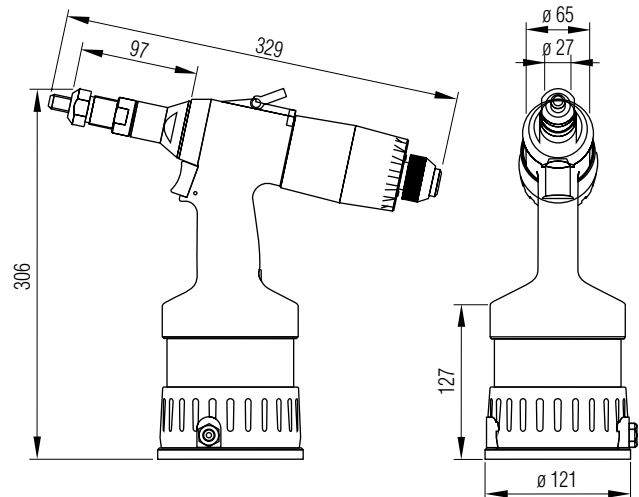

Spare parts / Consumables

Thread size	Nose piece Article No.	Threaded mandrel Article No.	Internal threaded mandrel Article No.
M6	348 382 870	348 381 870	
M8	348 318 870	348 308 870	
M10	348 320 870	348 310 870	
M12	348 322 870	348 312 870	
M14	348 324 870	348 314 870	
M16	348 326 870	348 316 870	

Optional accessories

Description	Article No.
Hydraulic oil 1 l	460 299 870



ProSert™ XTN20

Hydropneumatic blind rivet nut tool for installing M3 - M10 blind rivet nuts and M3 - M10 blind rivet studs

Benefits at a glance

- Patented dual operating technology, with power control or motion control on request
- Flexible when using various thread sizes and grip ranges
- Focus on only a handful of tools in the workplace
- High power-to-weight ratio of 11.1 kN/kg
- Tool-less stroke and pressure settings
- No tools required to replace threaded mandrel
- Low maintenance due to high-strength threaded mandrels
- Practical spin-off button
- First-rate ergonomic handling
- Lightweight at just 1.59 kg



Technical specifications

Stroke:	3.0 – 7.0 mm
Insertion force:	17.6 kN at 5 bar
Air consumption per rivet:	approx. 6.5 l
Air supply pressure:	5 – 7 bar
Air supply:	ø 6 mm (G1/4")
Weight:	1.6 kg

Scope of delivery

ProSert XTN20 blind rivet nut tool
Threaded mandrels: M4, M5, M6, M8
Nose pieces: M4, M5, M6, M8
Maintenance kit
Operating Instructions
Article No. 347 000 000*

* 1/4" air supply coupling sold separately

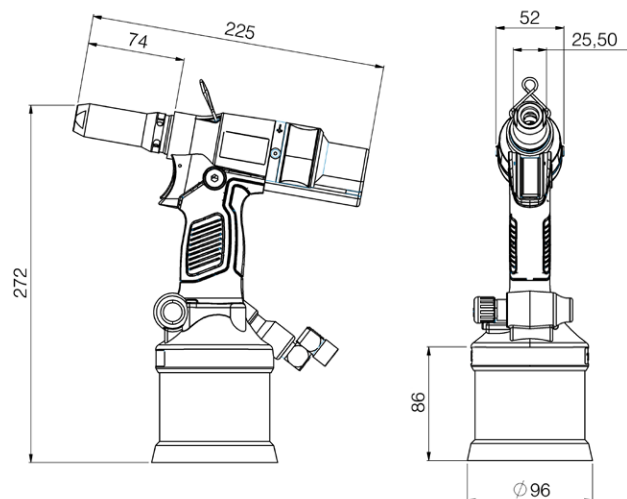

Working range

Blind rivet nuts	M3	M4	M5	M6	M8	M10
Aluminium	•	•*	•*	•*	•*	•
Steel	•	•*	•*	•*	•*	
Stainless steel		•*	•*	•		

* For use with blind rivet studs

Spare parts / Consumables

Thread size	Pulling unit* complete Article No.	Nose piece Article No.	Threaded mandrel Article No.	Mandrel extended by 15 mm Article No.	Drive mandrel Article No.	Guide bush Article No.
M3	347 000 140	347 000 129	347 000 130		347 000 131	
M4	347 000 119	347 000 104	347 000 100		347 000 115	347 000 111
M5	347 000 120	347 000 105	347 000 101	347 000 901	347 000 116	347 000 112
M6	347 000 121	347 000 106	347 000 102	347 000 902	347 000 117	347 000 113
M8	347 000 122	347 000 107	347 000 103	347 000 903	347 000 118	347 000 114
M10				347 000 904		

* All sizes come supplied with the required lock nut Article No. 347 000 108.

RL 6100

Hydropneumatic hexagonal cutter for cutting hexagonal holes

Benefits at a glance

- Big on performance, small in size
- Wall thicknesses: steel up to 5 mm and aluminium up to 6 mm
- Entire process triggered from one single button
- Sturdy design
- Easy to use; requires little maintenance
- Easy-change cutter
- Low-noise
- Air supply fittable on left or right
- Fixing point for balancer
- Safety valve prevents operating pressure overload

Technical specifications

Stroke:	9 mm
Insertion force:	34 kN at 6 bar
Installation force/Weight ratio:	11.7 kN/kg
Air consumption:	6.2 l/hole
Air supply pressure:	5 - 7 bar
Air supply:	ø 6 mm (G1/4")
Weight:	2.9 kg

Scope of delivery

TIOS 6100* hexagonal cutter
 Angled air supply
 Operating instructions
 Oil refill set
 Article No. 348 450 200*

* Supplied without stamp or nose piece.

Consumables

Description	Article No.
Nose piece M4	349 780 001
Cutter for M4 1 to 6 mm	349 764 000
Nose piece M5	349 781 001
Cutter for M5 1 to 6 mm	349 742 000
Nose piece M6	349 782 001
Cutter for M6 1 to 6 mm	349 743 000
Nose piece M8	349 783 001
Cutter for M8 1 to 6 mm	349 751 000
Nose piece M10	349 784 001
Cutter for M10 1 to 6 mm	349 771 870
M10 retooling kit	349 772 870

* The M10 retooling set is required to retool to an M10 stamp.

Optional accessories

Description	Article No.
Hydraulic oil 1 l	460 299 870

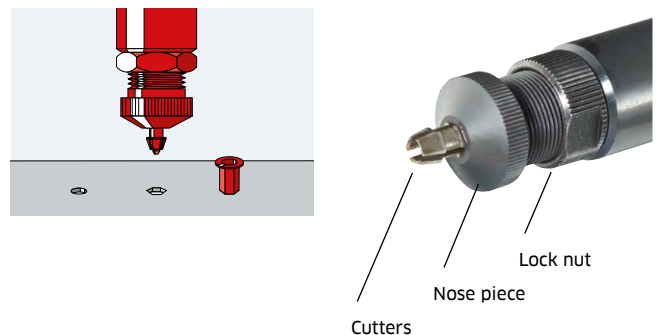
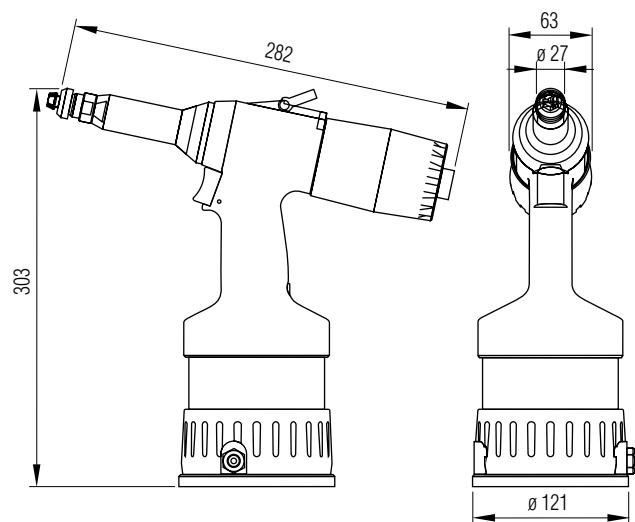



Working range (material thickness in mm)

Thread size	Hexagonal hole SW** [mm]	Bore ϕ [mm]	Material	Material strength [Mpa]					
				100	200	300	400	500	600
M4*	6.1	6.2 - 6.4	Steel			5.8	5.0	4.5	4.0
			Duralumin (Al)	6.0	6.0	6.0	6.0	5.7	
M5*	7.1	7.2 - 7.4	Steel			5.0	4.3	3.9	3.5
			Duralumin (Al)	6.0	6.0	5.6	5.2	4.9	
M6*	9.1	9.3 - 9.5	Steel			4.1	3.5	3.2	2.9
			Duralumin (Al)	5.5	5.0	4.6	4.3	4.0	
M8*	11.1	11.3 - 11.5	Steel			3.5	3.1	2.8	2.6
			Duralumin (Al)	4.6	4.2	3.9	3.7	3.5	
M10*	13.1	13.3 - 13.5	Steel			3.0	2.6	2.4	2.0
			Duralumin (Al)	4.4	4.1	3.7	3.2	3.0	

* Size of fastener, hole diameter prior to cutting

** SW = wrench size from hexagon