

Hydraulic assembly press/unit

The hydraulic assembly press is ideal for securely installing self-clinching fasteners. The high-quality components ensure that the assembly press always runs reliably and requires little maintenance. With an installation force of 70 kN, every standard self-clinching fastener can be installed using this machine. With its extensive range of accessories, the LSC 7010 with HA 200 offers additional practical and economic means of working with metals, e.g. clinching, edging or chamfering.

Benefits at a glance

- Optimum installation force settings
- Electronic and mechanical safety system
- The mechanical safety system makes the installation of non-conductive fasteners possible.
- Powered by standard mains supply (400V)
- Easy to use, quick retooling times
- Low maintenance and service
- Excellent price-to-performance ratio

C-frame LSC 7010

Technical specifications

Height:	1897 mm
Width:	812 mm
Depth:	1000 mm
Weight:	250 kg
Max. press-in force:	70 kN
Protrusion:	520 mm
Operating stroke:	130 mm

Article No. 463 300 201



HA 200 hydraulic unit

Technical specifications

Height:	845 mm
Width:	515 mm
Depth:	670 mm
Weight:	110 kg
Max. pressure:	220 bar
Nominal voltage:	3/N/PE 400/230V AC
Rated frequency:	50 Hz
Rated current:	max. 4.0 A
Wattage:	1.5 kW

Article No. 463 300 200



pressti® die parts

Size	T [mm]	L [mm]	Weight approx. [kg/item]	Description	Article No.
Long	16	68	0.3	VI00001418	463 300 001
Short	16	34	0.3	VI00001417	463 300 002
Wide	50	32	0.4	VI00001666	463 300 003

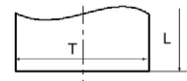

pressti® template for self-clinching nuts

Thread size	D [mm]	Weight approx. [kg/item]	Description	Article No.
M2 / M2.5 / M3	6.3	0.3	VI00001426	463 300 004
M4	7.9	0.3	VI00001428	463 300 005
M5	8.7	0.3	VI00001429	463 300 006
M6	11.05	0.3	VI00001430	463 300 007
M8	12.65	0.3	VI00001431	463 300 008
M10	17.35	0.3	VI00001432	463 300 009

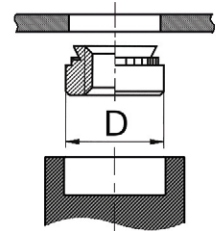

pressti® template for self-clinching studs

Thread size	D [mm]	Weight approx. [kg/item]	Description	Article No.
M2.5	2.5	0.3	VI00001419	463 300 010
M3	3.0	0.3	VI00001420	463 300 011
M4	4.0	0.3	VI00001421	463 300 012
M5	5.0	0.3	VI00001422	463 300 013
M6	6.0	0.3	VI00001423	463 300 014
M8	8.0	0.3	VI00001424	463 300 015
M10	10.0	0.3	VI00001425	463 300 016

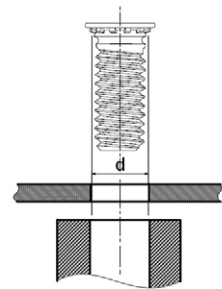

pressti® template for self-clinching studs

Thread size	D [mm]	Weight approx. [kg/item]	Description	Article No.
M2 - M3	4.2	0.3	VI00001421	463 300 012
M3	5.4	0.3	VI00001422	463 300 013
M4 - M5	7.2	0.3	VI00001441	463 300 019

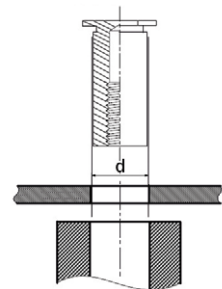

Other possible uses for the LSC 7010

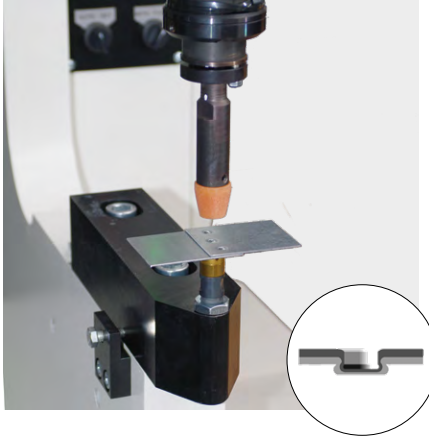

Clinching / Metal joining:

This method replaces the conventional spot welding of thin sheeting.

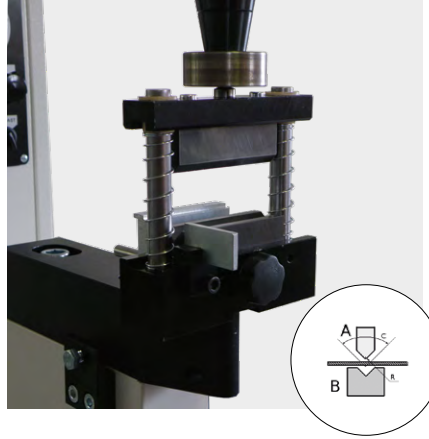

Bending / Chamfering:

This press makes light work of bending and chamfering thin sheeting up to a maximum width of 80 mm and a thickness of 2 - 3 mm depending on the material. It also comes fitted with side and end stops. Depending on the requirements, these can be set to 9 - 70 mm.

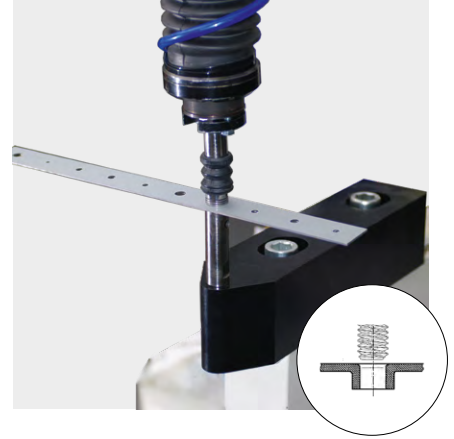

Edging:

This technology extends the surface when tapping thin sheeting of between 0.8 and 2 mm thickness.